

sezione C-C - stato di fatto
scala 1:50

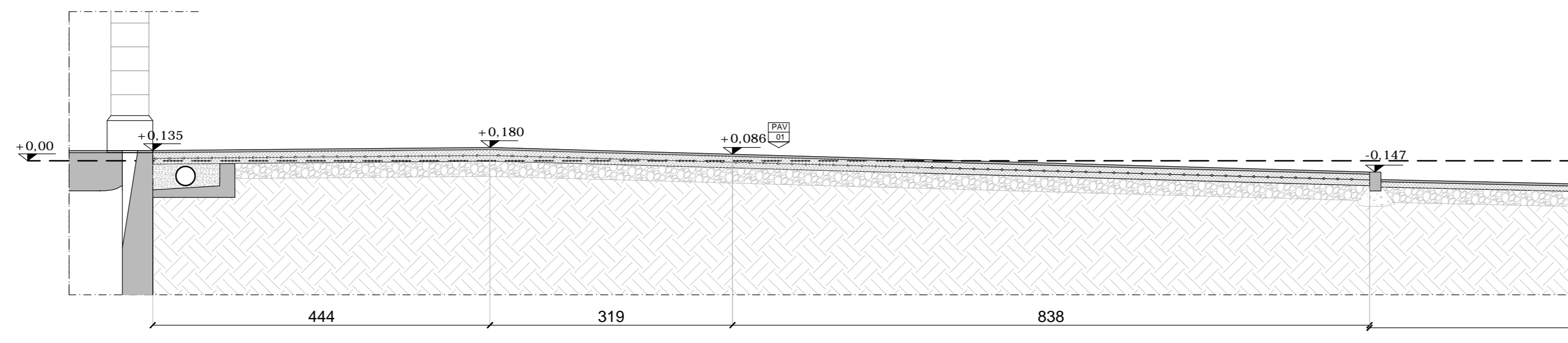

sezione C-C - progetto
scala 1:50

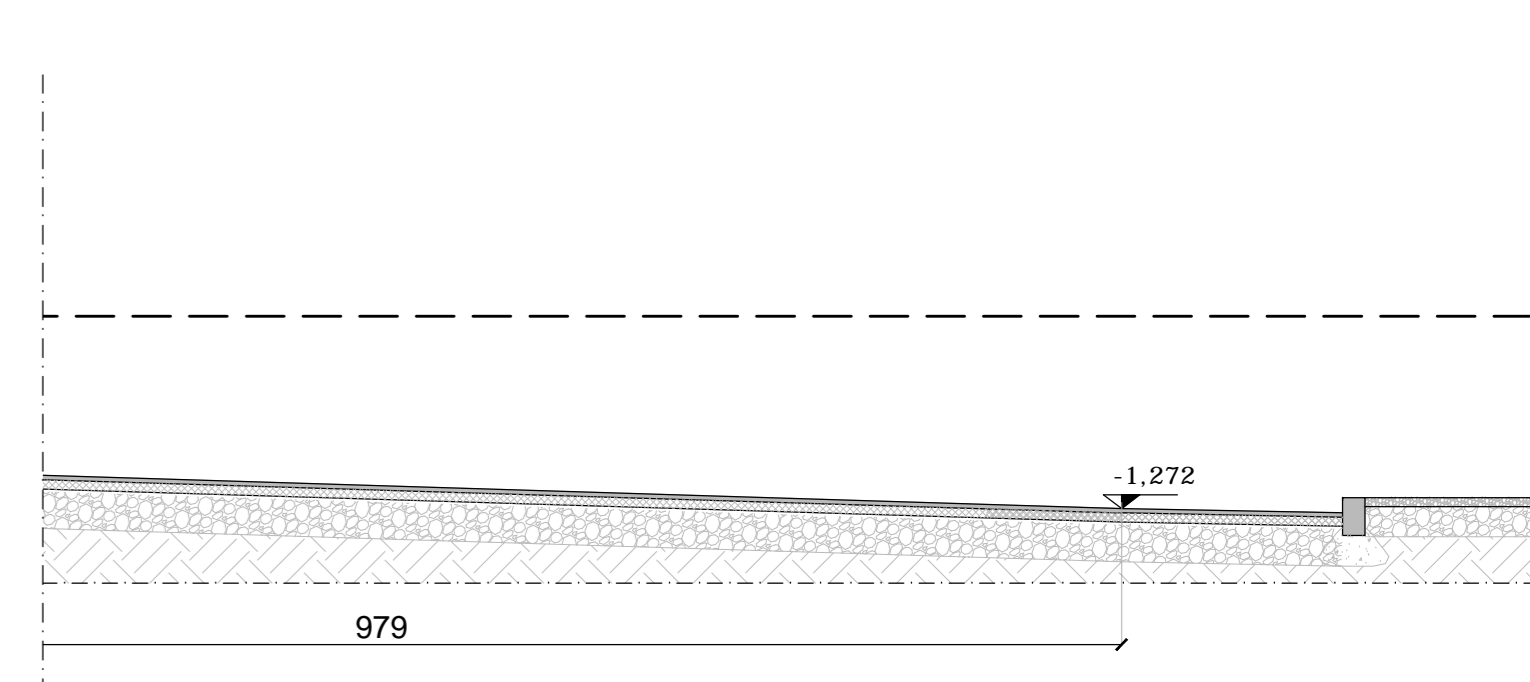
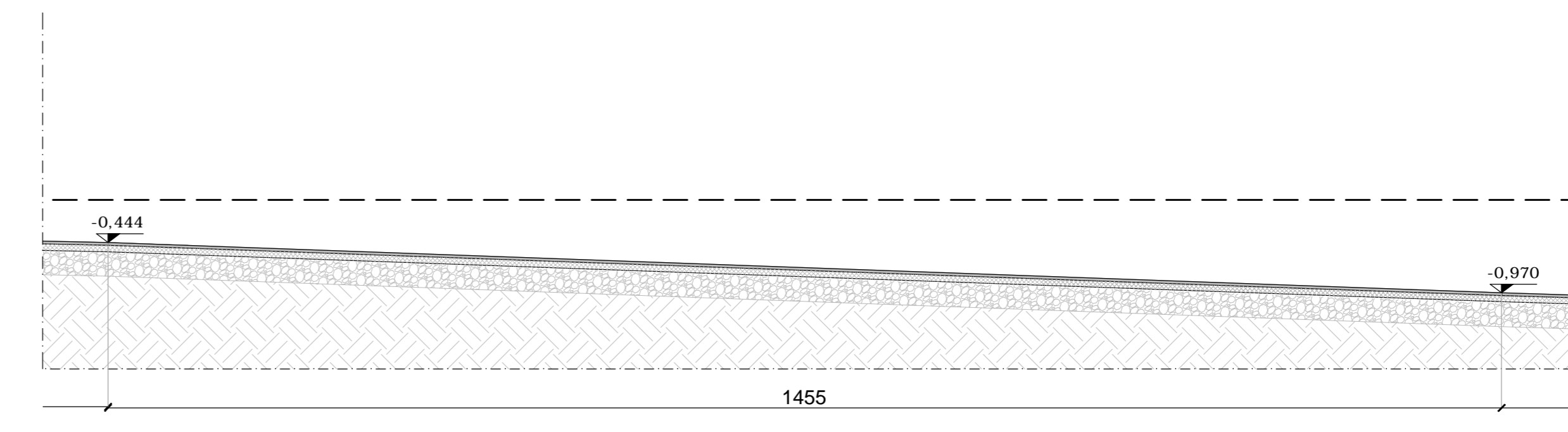
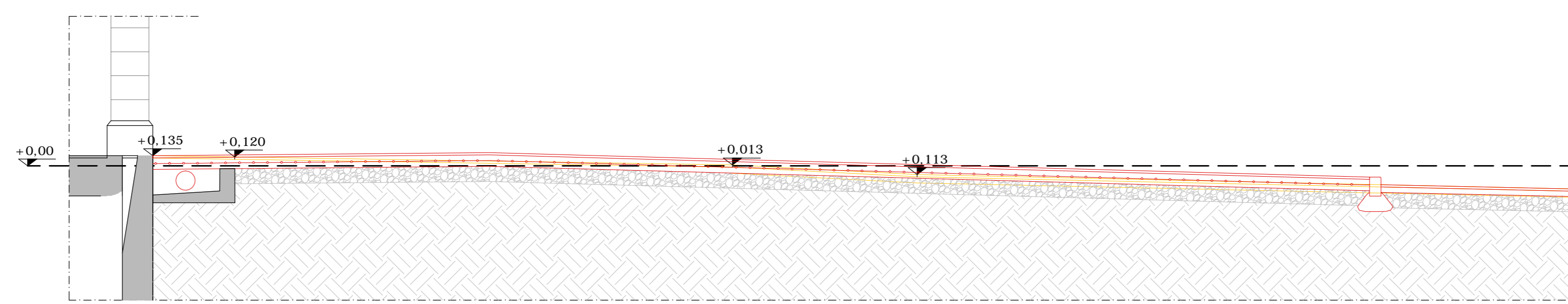
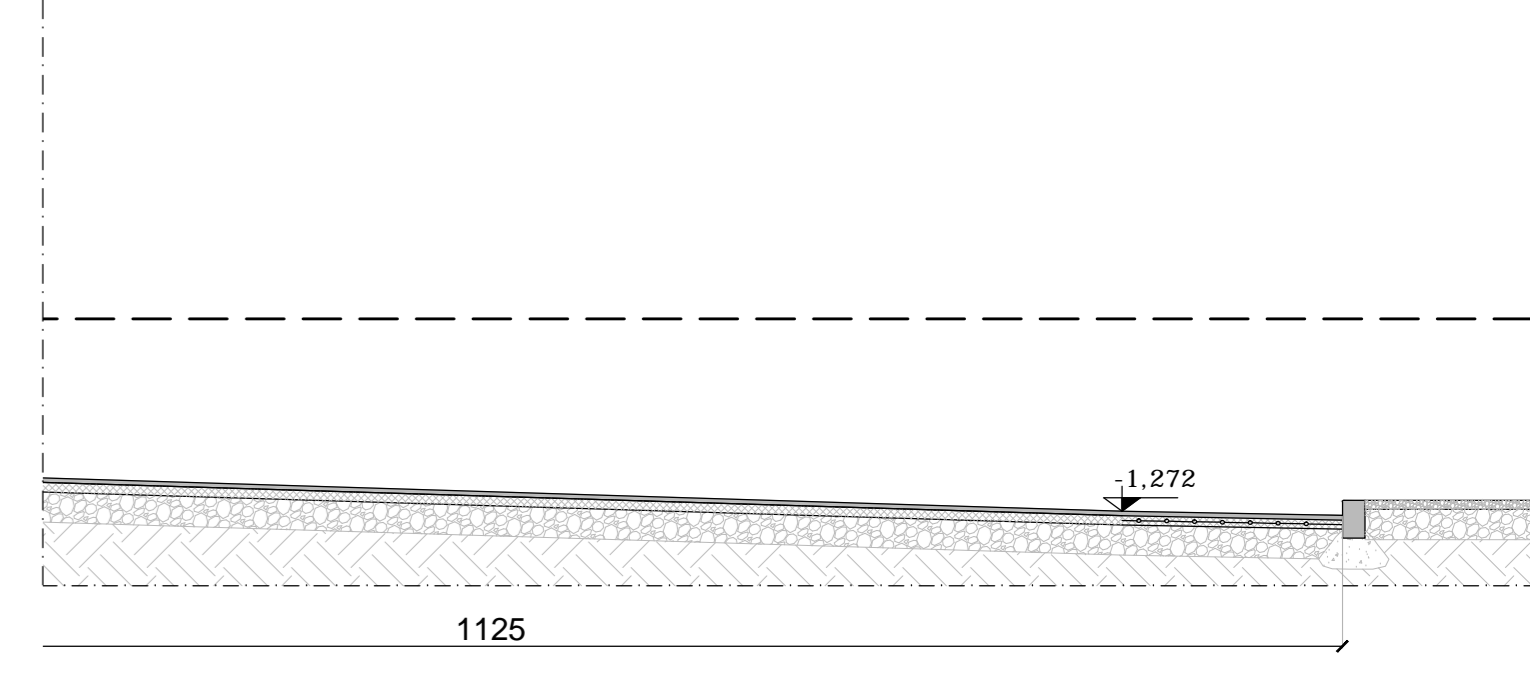
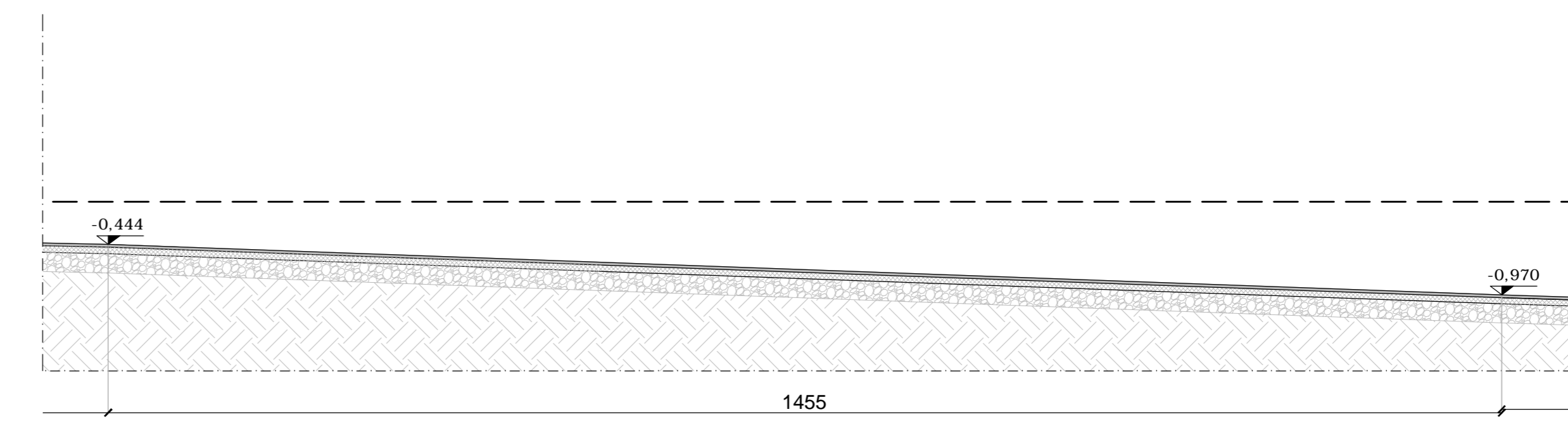

sezione C-C - sovrapposizione
scala 1:50

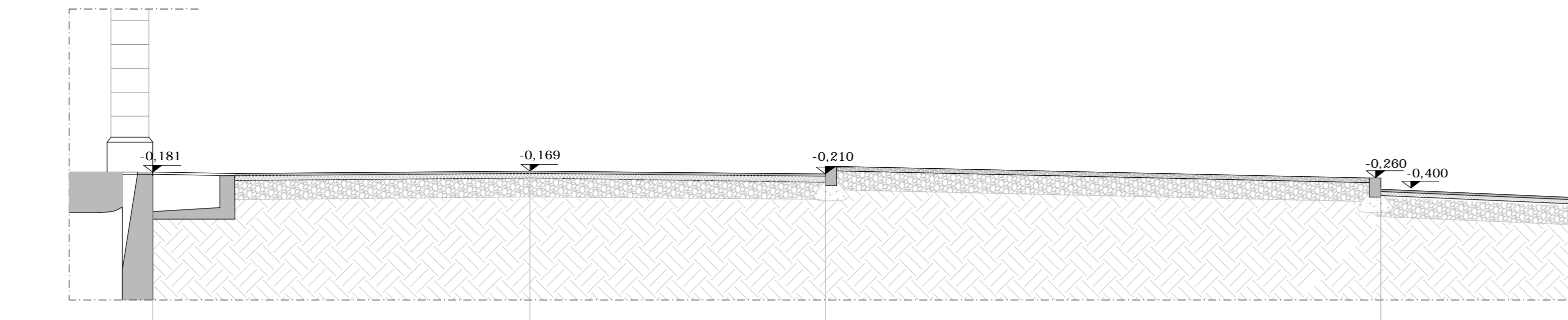
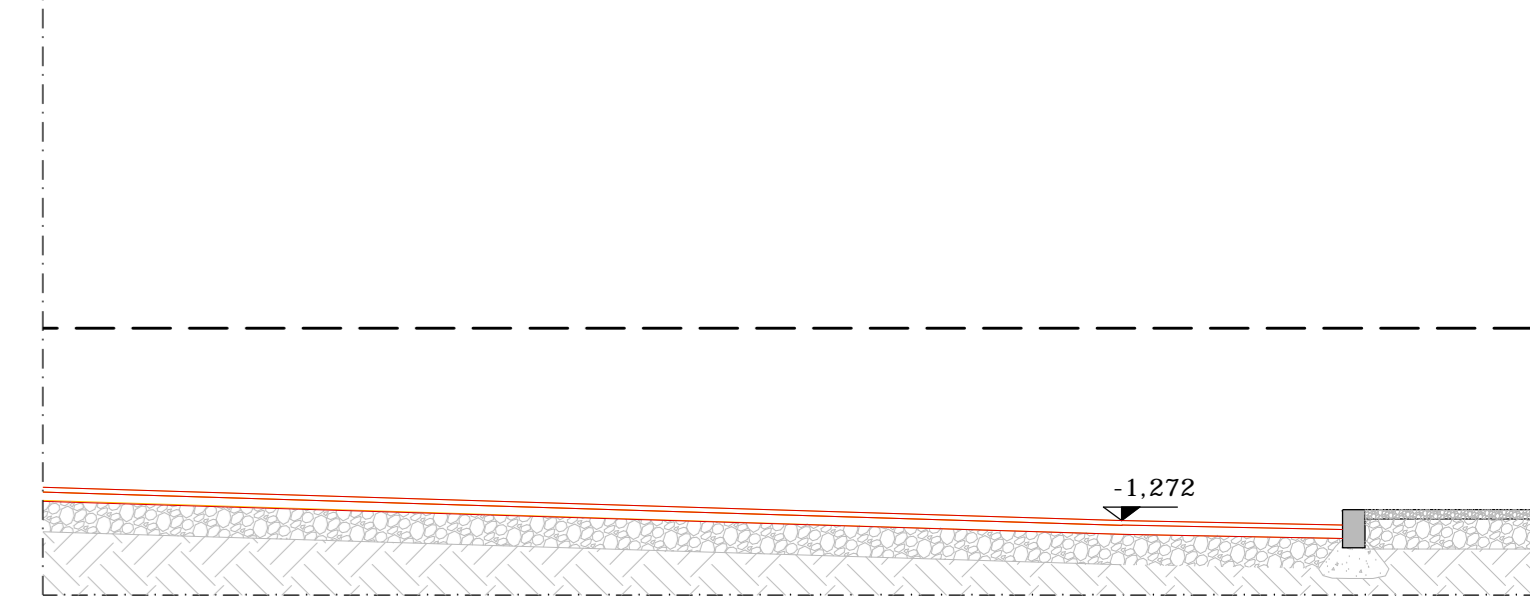
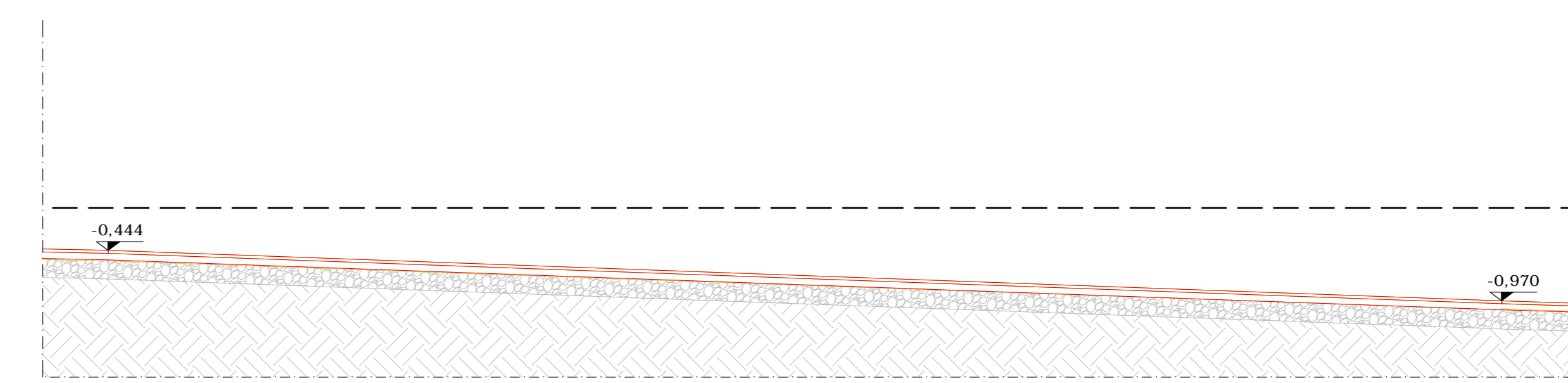

sezione D-D - stato di fatto
scala 1:50

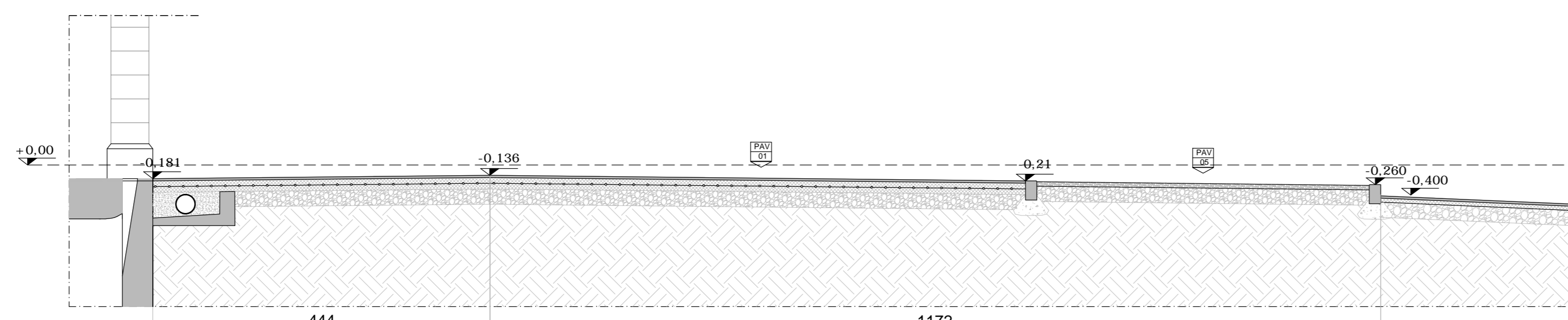
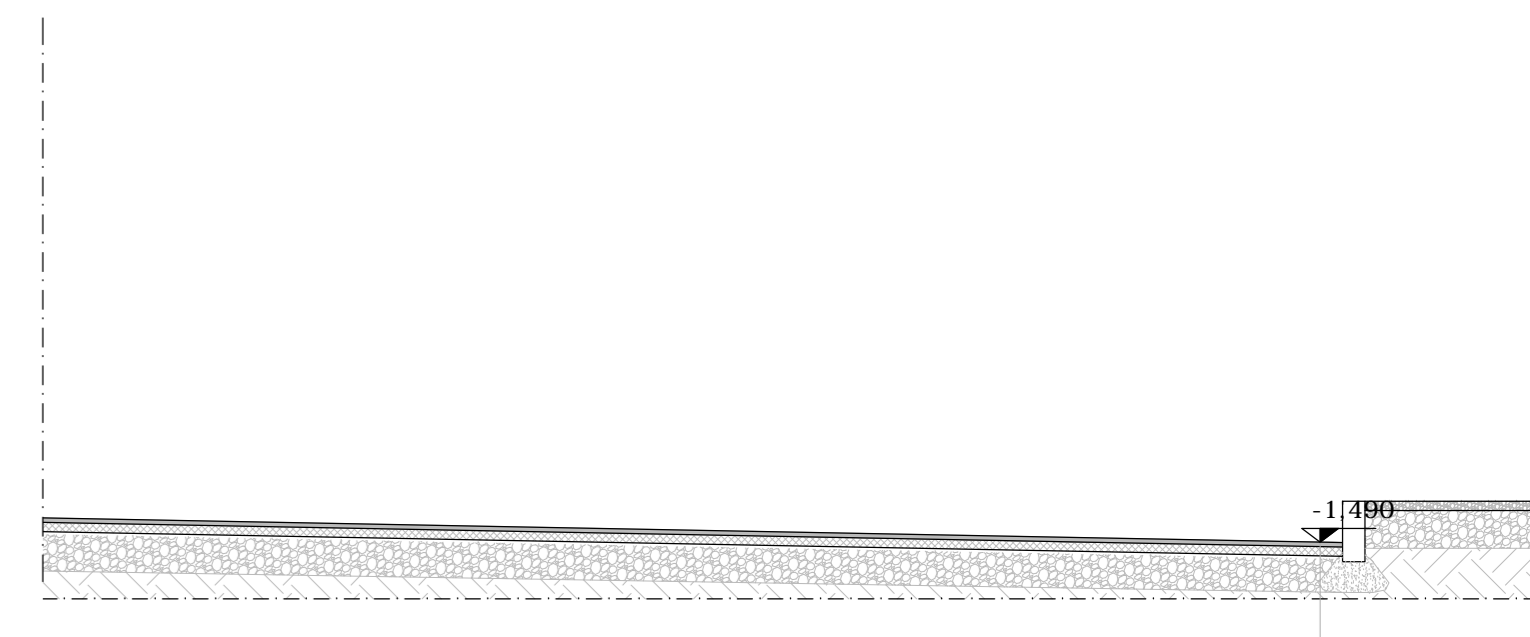
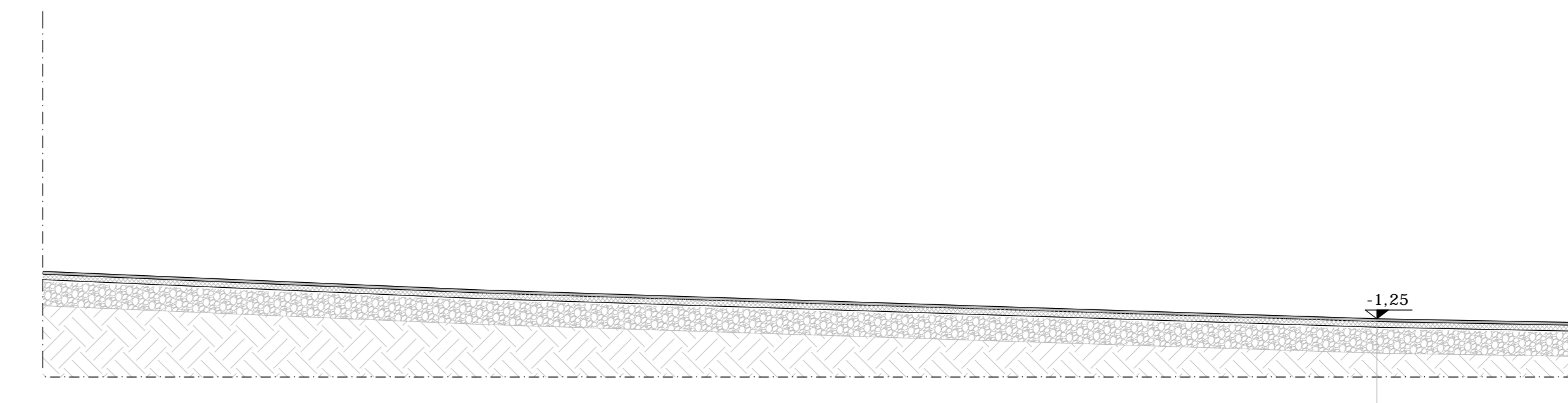

sezione D-D - progetto
scala 1:50

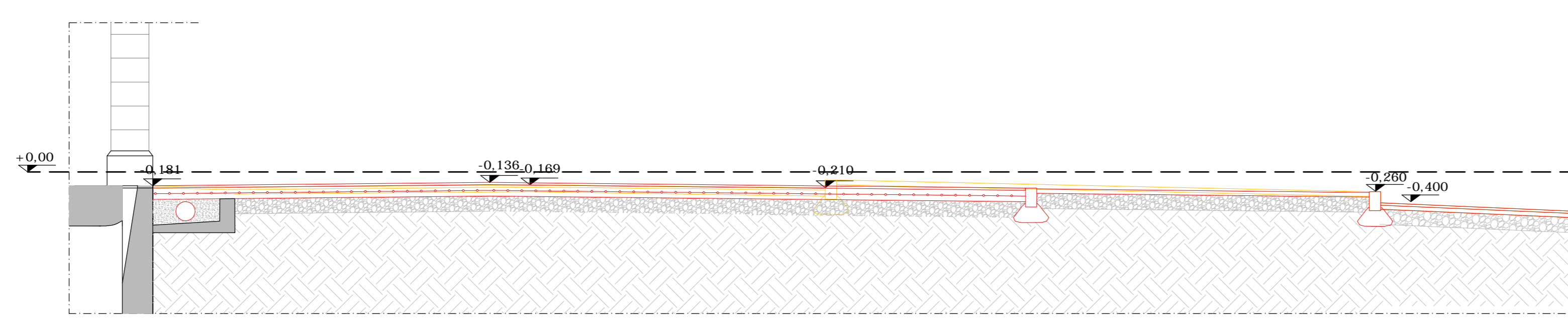
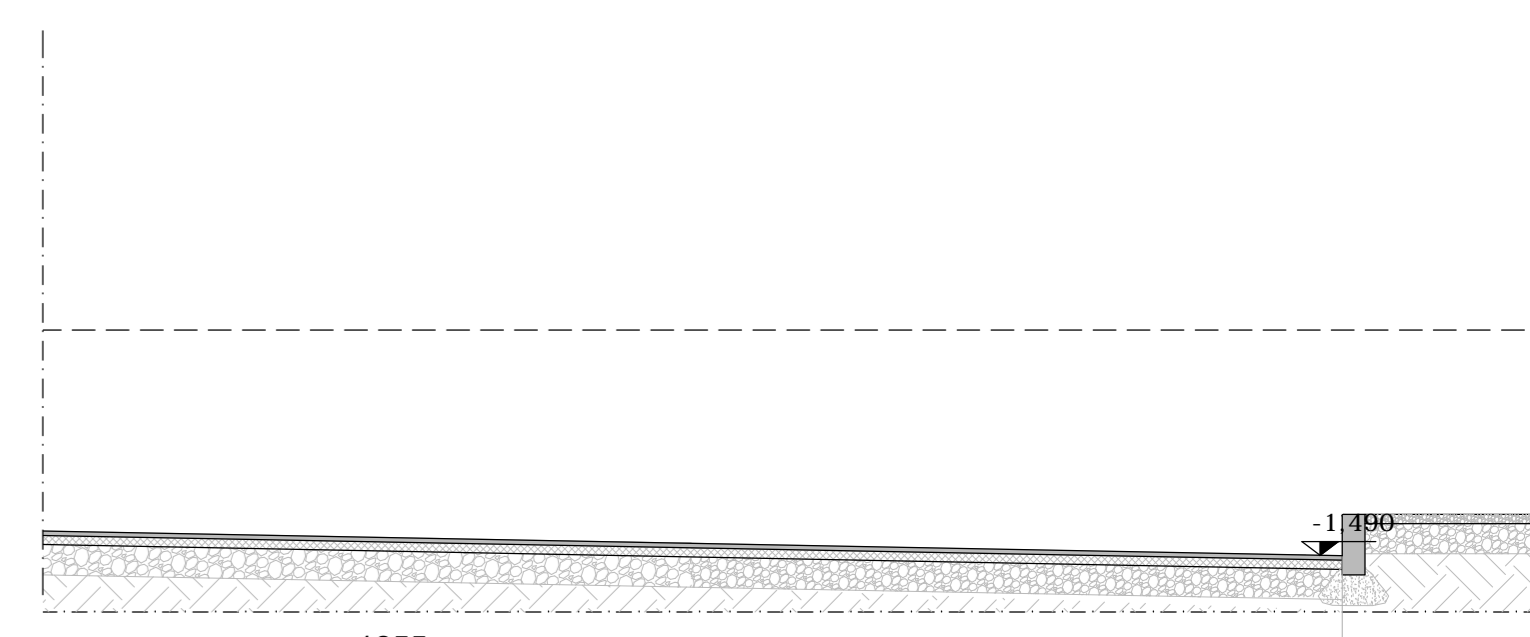
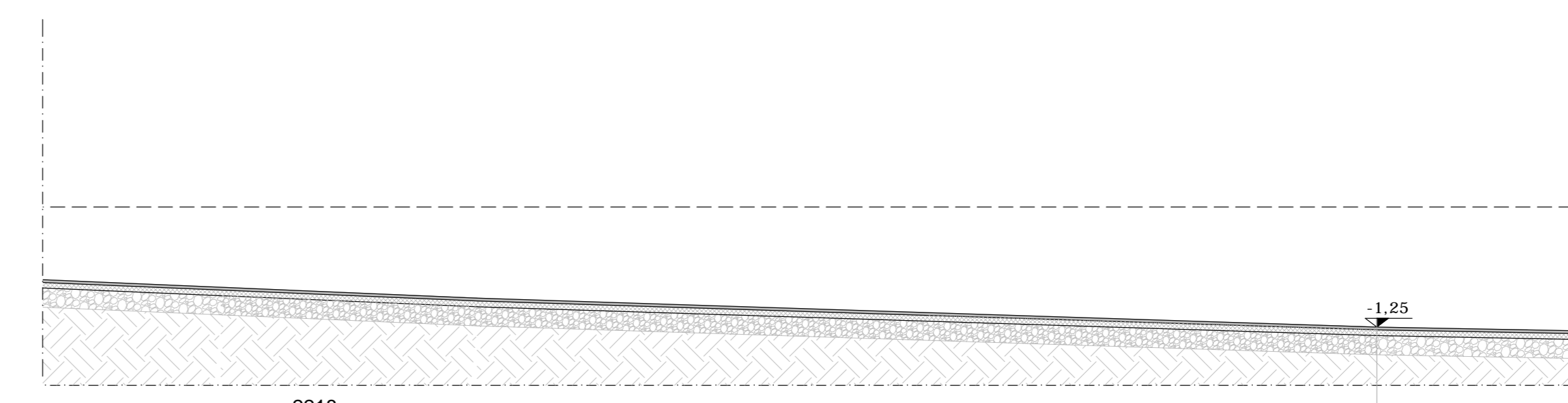

sezione D-D - sovrapposizione
scala 1:50

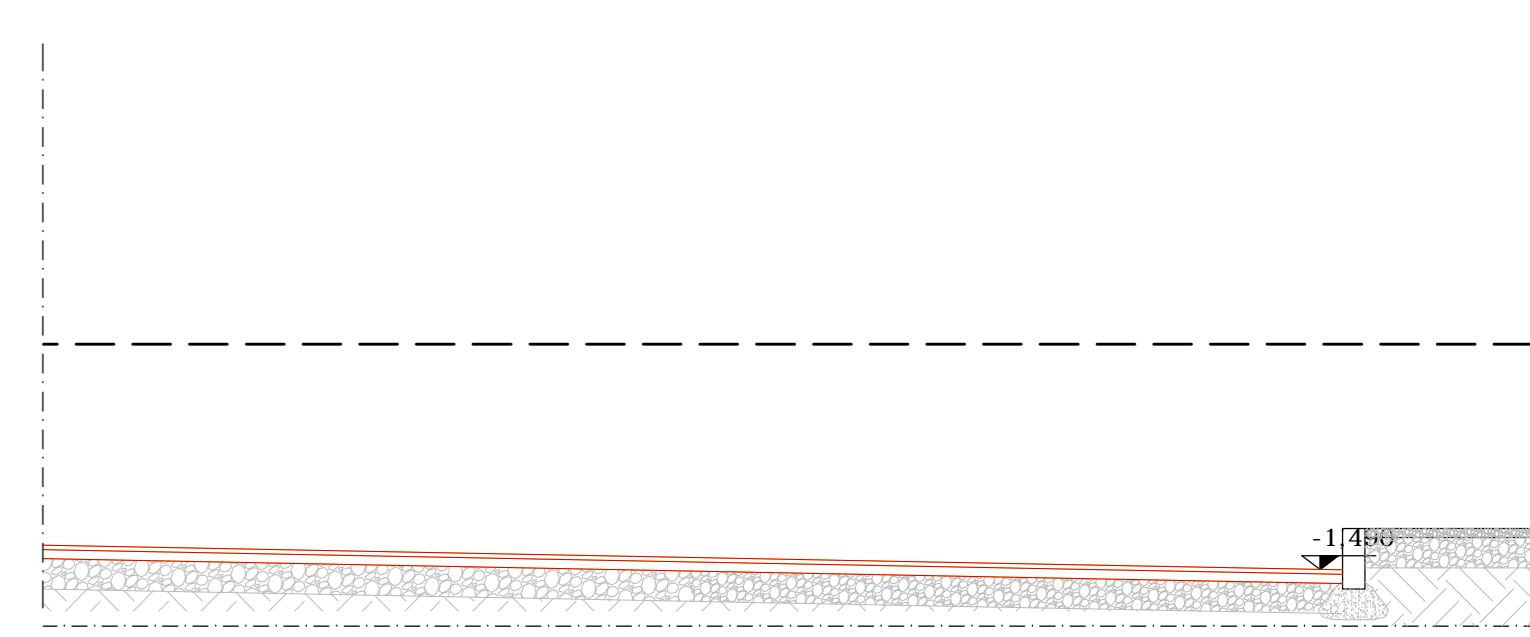
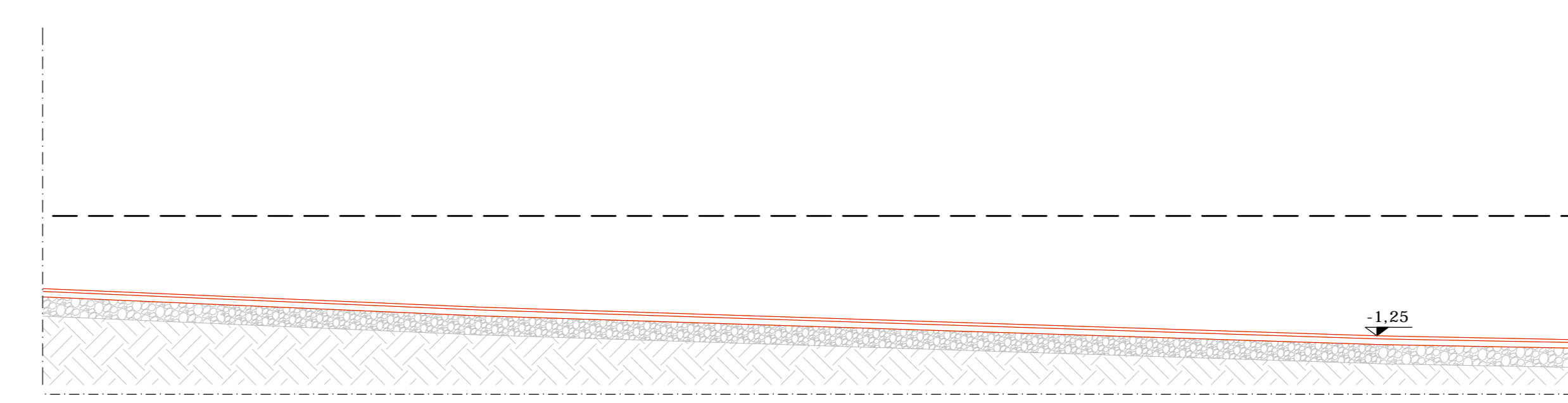

- LEGENDA**
- PAV 01 pavimentazione in pietra di Luserna taglio sega
 - PAV 02 pavimentazione in pietra di Luserna a spacco
 - PAV 03 pavimentazione in cubetti di pietra di Luserna
 - PAV 04 manto erboso
 - PAV 05 ghiaietto
 - PAV 06 area asfaltata

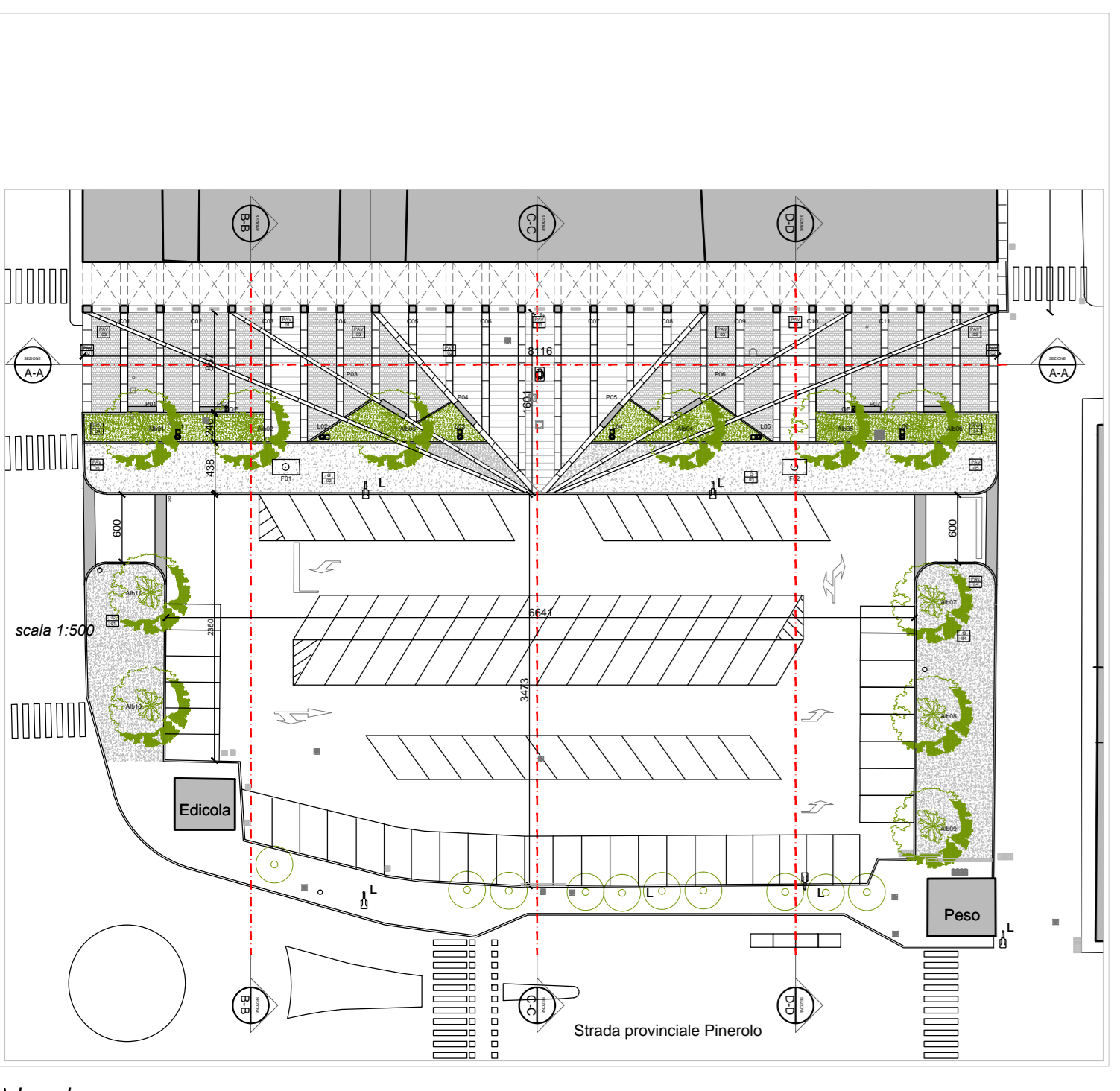

keyplan
scala 1:500

REGIONE PIEMONTE
Città Metropolitana di Torino
COMUNE DI LUSERNA SAN GIOVANNI

PROGETTO ESECUTIVO

**RIQUALIFICAZIONE PIAZZA PARTIGIANI
E ANNESSA VIA ROMA**

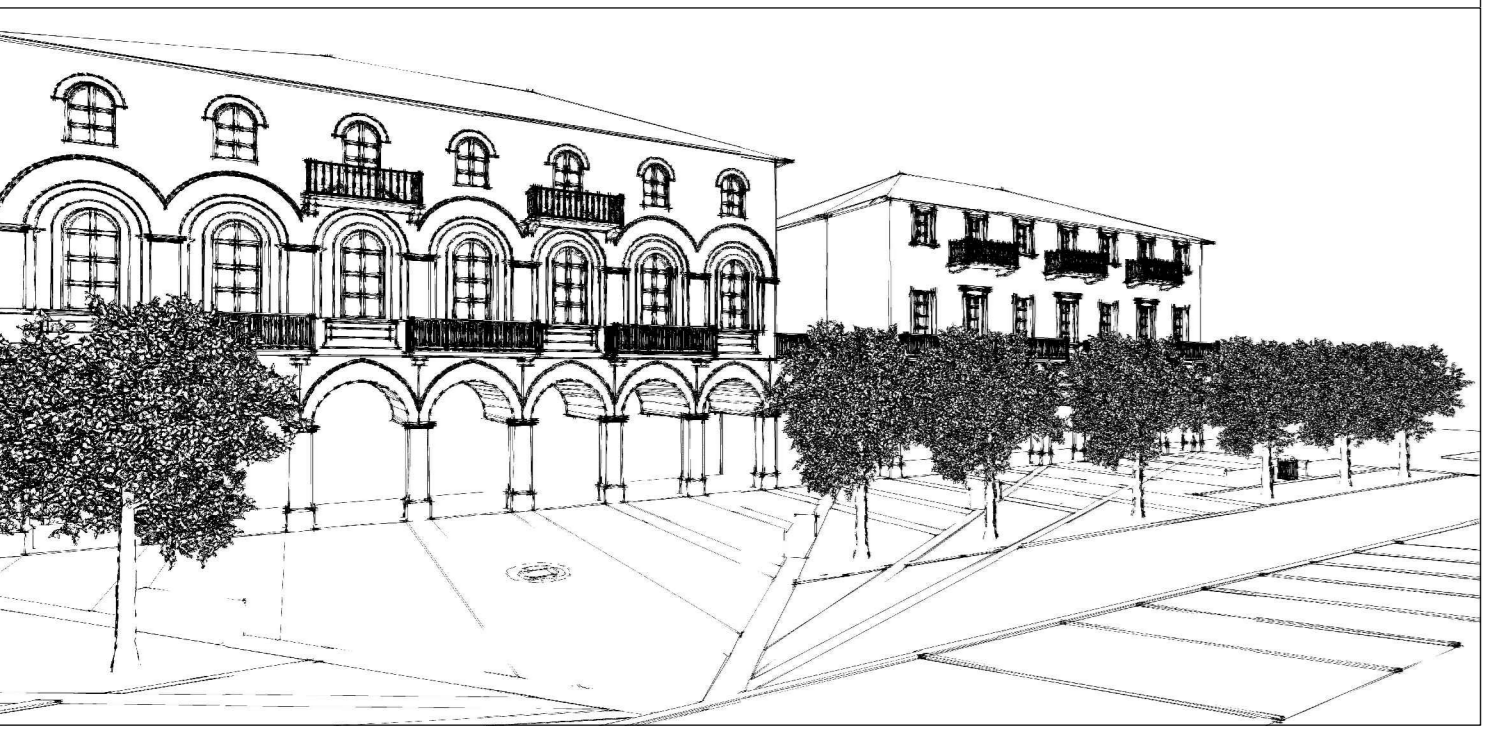

IL PROGETTISTA	
PROGETTISTI:	ARCHITETTO MASSIMILIANO CLARA
Arch. Massimiliano Clara	
IL R.U.P.	
DATA:	30/03/2017
SCALA:	1:50
TAVOLA:	A05
OGGETTO:	SEZIONI STRADALI CC - DD
ARCHITETTO MASSIMILIANO CLARA Piazza Vigliardi Paravia 3D_10144_massimiliano.clara@astarstudio.it	